



Guernsey 34



Guernsey 28



Guernsey

A unique and relaxing new experience



Guernsey 28

If you like sea trips or fishing excursions with friends, the Guernsey 28 will seduce you with its distinguished lines, its high level of equipment, the power of its engine, its manoeuvrability and the quality of its internal fittings.



Guernsey 34

You are an experienced and demanding sailor, an enthusiast for cruises or fishing excursions. The Guernsey 34 is made for you.

In fact, this 11 meters launch with superb lines combines up to date technologies, power and performance, high quality equipment and exceptional on board comfort that will delight your guests.

NEW : dual engine installation available as of May 2008.



Guernsey

A unique and relaxing new experience

Superb lines, superior power and performance, high quality, impeccable finishes and real on board conviviality, ... guaranteed sea going pleasure!

Welcome on board these 2 boats born from up to date and renowned know-how: Guernsey 28 and Guernsey 34.

The Guernsey 28 and 34 models offer ultra high performance equipment to ensure easy and completely safe navigation: bow thruster, stainless steel keel protection, electric windlass... Hurry to discover which is the best for your requirements.



Fittings and finishes

Live and share the pleasure of life at sea



Elegant, slender, seductive and welcoming.

The elegant silhouette of the Guernsey 28 encloses a vast, light interior and magnificent wood finishes. The captain has the benefit of excellent visibility and all the navigation instruments within reach. The interior offers maximum comfort (fitted kitchen with double hot plate, refrigerator, separate bathroom with shower and marine WC, radio/CD equipment...). Everything for a warm welcome for your friends.

With its classic lines, the Guernsey 28 seduces at the first glance. The boat has a huge cockpit and boarding is easy. Everything in the boat is designed by specialists for connoisseurs. Keen on excursions or sea fishing? Every one finds their own pleasure. The cockpit includes several rod holders and lockers. The sun deck and large rear platform await you for complete relaxation. Because a pleasure is all the more intense when it is shared.





Guernsey 28

An exclusive choice of colours



You can choose the colour of your hull : navy blue, burgundy or cream.

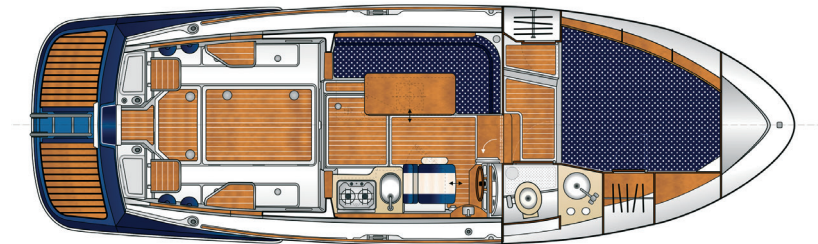
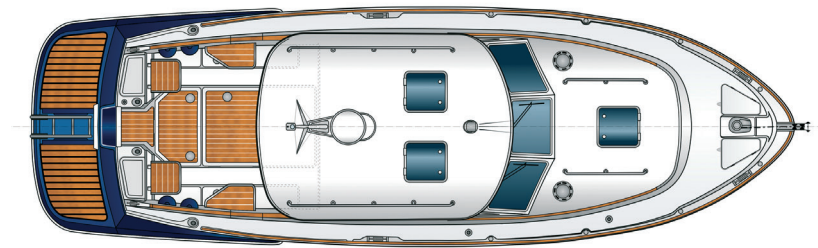

Technical specifications

- | | | | |
|--------------------------------|--------------------|-----------------------------|-------------------------|
| • Length of hull with platform | 9,50 m | • Engine : | Cummins MerCruiser |
| • Length of hull | 8,48 m | | Diesel QSD 4,2 L 320 HP |
| • Beam max. | 2,99 m | • Fuel capacity | 400 L |
| • Beam hull | 2,94 m | • Water tank capacity | 180 L |
| • Draft | 0,95 m | • Boiler capacity | 25 L |
| • Cockpit dimensions | 2,05 x 2,1 x 0,9 m | • Black water tank capacity | 61 L |
| • Weight with engine | 4300 kg | • Berths | 6 |
| | | • Number of persons | 8 |
| | | • EC category | B |



Guernsey 28



Do you want complete freedom of the seas? Choose the Guernsey 28, a friendly and elegant launch that will never cease astonishing you, you and your friends. Whether you go to sea for a fishing trip, or quite simply for a relaxing afternoon. Measuring 9m50, this boat offers all the space required for adventure and can accommodate many passengers. You can invite up to eight crew members and accommodate six on board.





Convivial & refined interior



With the Guernsey 34, inviting family and friends to take part in a cruise is a real pleasure. On board, everything has been designed to make your life easy and extend to your guests the warmest of welcomes, with uncompromising levels of comfort.

Irreproachable behaviour: flowing lines, up-to-date technologies, perfect handling and stability on the water, even in difficult sea conditions, safety.

The interior fittings are luxurious and very comfortable: a fitted kitchen with double burners, oven and refrigerator, a separate bathroom with shower and marine toilet, a CD/radio in the cockpit as well as a large sun pad at the bow. A double door has now been fitted as standard.

*Sea voyages: A pleasure to be shared
without moderation*



Colours & Specifications



An exclusive choice of colours and options



The equipment, comfort and finish of the Guernsey 34 testify once more to Guernsey's know-how and expertise, and guarantee you unforgettable sea trips.



In the basic version, you already have the choice of three hull colours : navy blue, cream or burgundy.

Various optional extras are available if you want to upgrade the basic equipment to meet your special requirements as a seasoned seafarer. With the Guernsey 34, you opt for quality, performance and style.

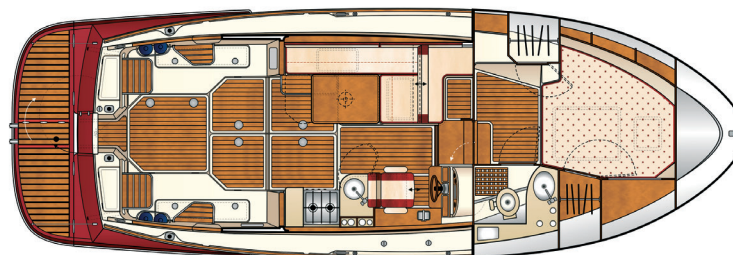
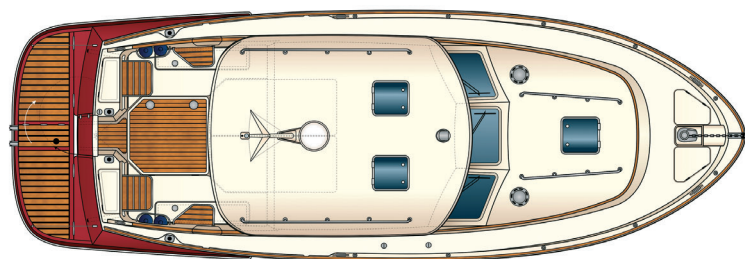



Guernsey 34



Technical specifications

- | | | | |
|------------------------|--------------------|-----------------------------|--------|
| • Length with platform | 11,35 m | • Single engine : | |
| • Length of hull | 10,00 m | Cummins Mercruiser | 425 HP |
| • Beam max | 3,85 m | Diesel 5.9L | |
| • Beam hull | 3,81 m | • NEW : dual engines | |
| • Draft | 1,10 m | Cummins Mercruiser | |
| • Cockpit dimensions | 2,2 x 2,7 x 0,95 m | Diesel 2 x 2.8L | 230 HP |
| • Weight with engine | 6350kg | • Fuel capacity | 520 L |
| | | • Water tank capacity | 250 L |
| | | • Boiler capacity | 50 L |
| | | • Black water tank capacity | 170 L |
| | | • Berths | 6 |
| | | • Number of persons | 10 |
| | | • EC category | B |

Options



Available options

- Electronics pack - Simrad (Radar, VHF, Chartplotter, Autopilot ...)
- Cabin heater with demister
- Generator 110 V - 220 V
- Comfort pack including teak laminate floor in cockpit and deluxe seats in the cockpit

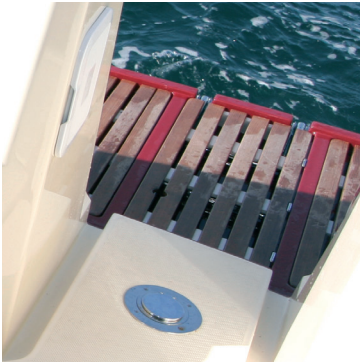

Guernsey 34

The Guernsey 34 is versatile and perfectly adapted to fishing as well as pleasure cruising. And she offers all the outstanding qualities: power, stability and cutting-edge navigation equipment.

Like all the models in the range, the Guernsey 34 is equipped with hydraulic steering for enhanced safety and comfort. The equipment for fishing and cruising testify to the detailed care taken in the design: more than adequate rod holders and cockpit lockers, stainless steel keel protection, livewell with seawater circulation, bow thruster, electric bow roller, and electric stern platform.

Enjoy your passion!

*Discover the varied
joys of sea fishing*





Guernsey 34



The Guernsey 34 has the image of a 'lobster boat'. This impressive 11-metre beauty benefits from the latest technologies and know-how.

This exceptional boat is intended for demanding skippers who want to combine the power and performance of a top-of-the-range vessel with the convivial ambience of sea trips with family or friends. Perfectly equipped for sea fishing, the Guernsey 34 also offers an exceptional onboard comfort.

Superb lines, luxury equipment and meticulous finishing all make it a star with real class. You discover its qualities at sea as never before: handling, stability, safety, elegance, etc.

Whether it's fishing or cruising, in good weather or difficult conditions, competing for a trophy or just for sheer relaxation, you are sure to enjoy a unique experience with the Guernsey 34!



Equipements Guernsey



Guernsey 28

- Gauges: Speedometer, tachometer, fuel & trim
- Wheelhouse: Electric switch panel with circuit breakers, full engine instrumentation, hydraulic steering
- Weather gauges (thermometer, barometer, clock)
- Compass
- Hydraulic Steering
- Bow thruster
- Electric windlass
- Stainless steel keel protection
- Emergency tiller
- 3 electric bilge pumps
- Electric horn
- Fire extinguishers (2 automatic in engine room + 1 in the pilothouse)
- 2 hydraulic & trim tabs
- 2 electric windscreen wipers
- Navigation and anchoring lights
- 220V & 12V electric installation + sockets
- Spot light
- Stern platform + stainless steel boarding ladder
- Shore power with battery charger
- Pressurized freshwater system
- Galley: sink & tap, pressurized fresh water, two burner cooker, cooker storage
- Folding cabin table
- Cockpit shower
- Toilet compartment (shower, sink & tap, marine toilet, cosmetics storage)
- CD / Radio + 4 speakers
- 25L hot water boiler
- 65L refrigerator
- Teak laminate floor
- Sundeck
- Aft wheelhouse closure with double door.
- 2 fender brackets in the cockpit with 2 fenders each
- 6 fenders
- 2 cockpit lockers
- 4 wooden cockpit benches
- 4 rod holders
- 4 opening oval portlights (2 starboard & 2 port)
- Opening window on starboard window
- 3 wheelhouse opening panels
- 2 cockpit lockers
- Stainless steel pulpit
- Fish locker
- Live well with electrical pump
- 6 mooring cleats : 2 bow, 2 mid-ship & 2 stern
- Bow roller
- Anchor locker
- Wooden handrails on the back of the cabin
- Stainless steel handrails on the top of the cabin and at the bow
- Wooden step in cockpit to access deck
- Interior lights
- Transom door
- Storage compartment in cabin (closet & shelves)



Guernsey 34

- Gauges: Speedometer, tachometer, fuel & trim
- Wheelhouse: Electric switch panel with circuit breakers, full engine instrumentation, hydraulic steering
- Compass
- Weather gauges (thermometer, barometer, clock)
- Hydraulic Steering
- Electric windlass
- 3 electric bilge pumps
- Electric horn
- Fire extinguishers (2 automatic in engine room + 1 in the pilothouse)
- 3 electric windscreen wipers
- Navigation and anchoring lights
- 220V & 12V electric installation + sockets
- Spot light
- Electric stern platform + stainless steel boarding ladder
- Shore power with battery charger
- Pressurized freshwater system
- Galley: sink & tap, pressurized fresh water, gas-stove, two burner cooker, cooker storage
- Folding cabin table
- Pressurized freshwater system
- Cockpit shower
- Toilet compartment (shower, sink & tap, marine toilet, cosmetics storage)
- CD / Radio + 4 speakers
- Teak laminate floor
- 65L refrigerator
- Sundeck
- NEW - Aft wheelhouse closure with double door
- 2 fender brackets in the cockpit with 2 fenders each
- 2 bow fender baskets with fender
- 2 cockpit lockers
- 4 wooden cockpit benches
- 4 rod holders
- 4 opening oval portlights (2 starboard & 2 port)
- Opening window on starboard window
- 3 wheelhouse opening panels
- Stainless steel pulpit
- Fish locker
- Livewell with electrical pump
- 6 mooring cleats : 2 bow, 2 mid-ship & 2 stern
- Davit
- Anchor locker
- Wooden handrails on the back of the cabin
- Stainless steel handrails on the top of the cabin and at the bow
- Wooden step in cockpit to access deck
- Transom door
- Interior lights
- Storage compartment in cabin (closet & shelves)

Options

Guernsey 28

- Hull colour = navy blue, burgundy or cream

Guernsey 34

- Electronic pack - Simrad (Radar, VHF, Chartplotter, Autopilot ...)
- Cabin heater with demister
- Generator 110V - 220 V
- Comfort pack including teak laminate floor in cockpit and deluxe seats in the cockpit



The Guernsey boats are designed by naval architect Jacek Centkowski, under the management of Brunswick Marine *in* EMEA.



BRUNSWICK MARINE *in* EMEA
ISO 9001 - 2000 CERTIFIED

The quality system of
Brunswick Marine *in* EMEA
is ISO 9001:2000 certified

Guernsey

© 2008 Brunswick Marine *in* EMEA – Printed in Belgium - 90-8M8021367-09 - All Rights Reserved.

Brunswick Marine *in* EMEA continuously explores means to improve the products it designs, manufactures and distributes. Every effort is made to produce sales and service literature which is current. Changes to specifications of engines, boats and accessories are ongoing. This brochure should not be regarded as a precise guide to the latest specifications. This brochure is also not an offer for sales of any particular engine, boat or accessory. Distributors and dealers are not agents of Brunswick Marine *in* EMEA or one of its affiliates and they have no authority to bind Brunswick Marine *in* EMEA by any express undertaking or representation, including but not limited to representations of product, sales, applications or service nature.

Not all products are available in all countries and some are available only in limited quantities. Some products shown in this catalogue are equipped with optional accessories.

Please see your local dealer.
Visit <http://www.BrunswickMarineEMEA.com>

www.guernsey-boats.com