

nauticat 42

September 2002

Standard specifications

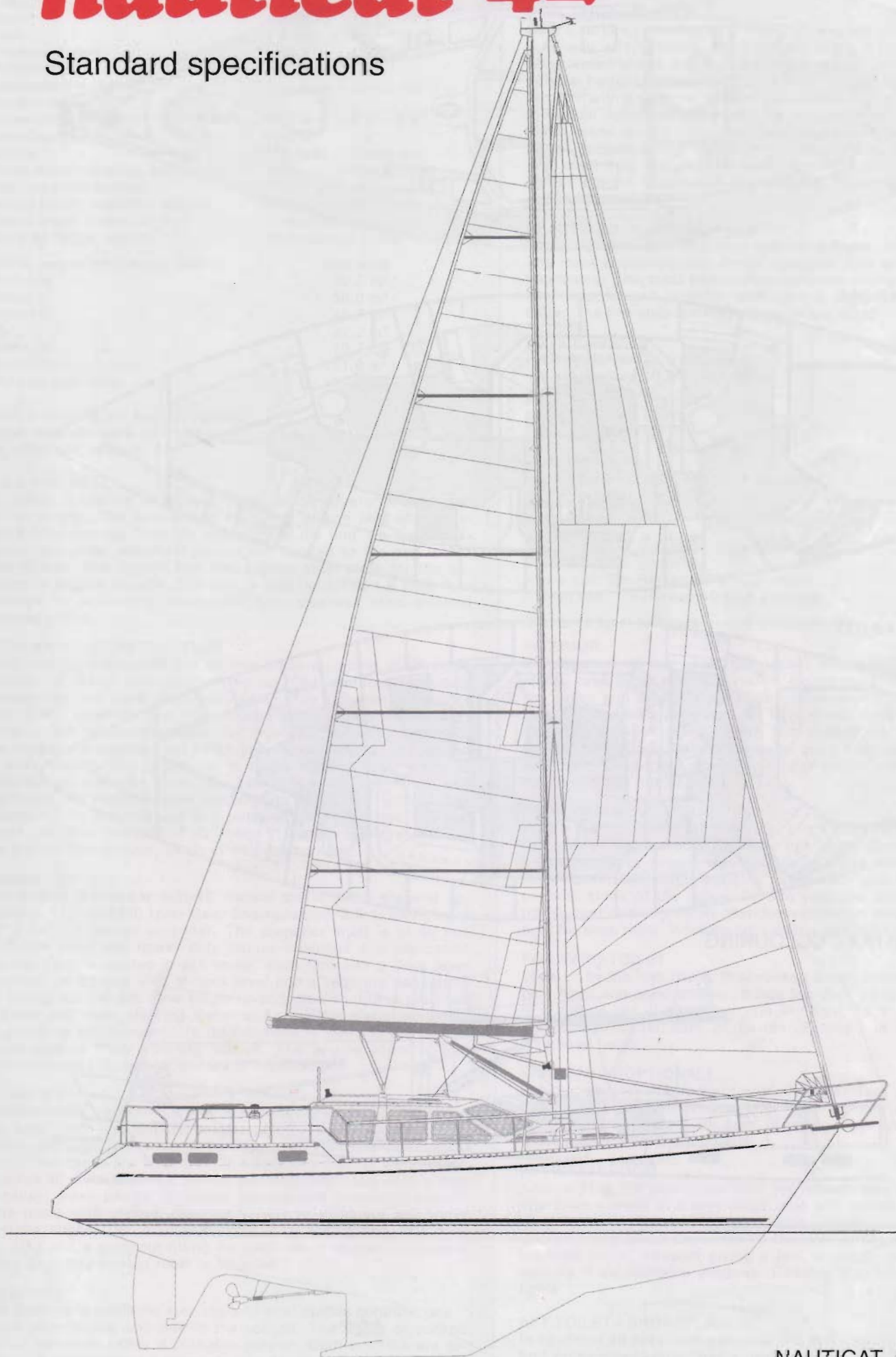

NAUTICAT 42 SLOOP

DECK LAYOUT

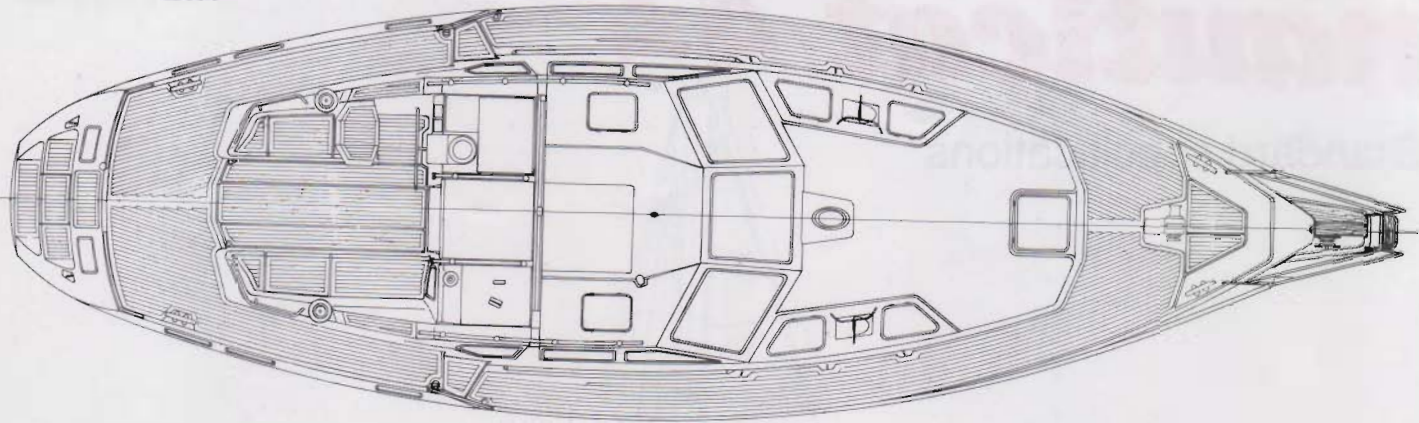

INTERIOR 42-011

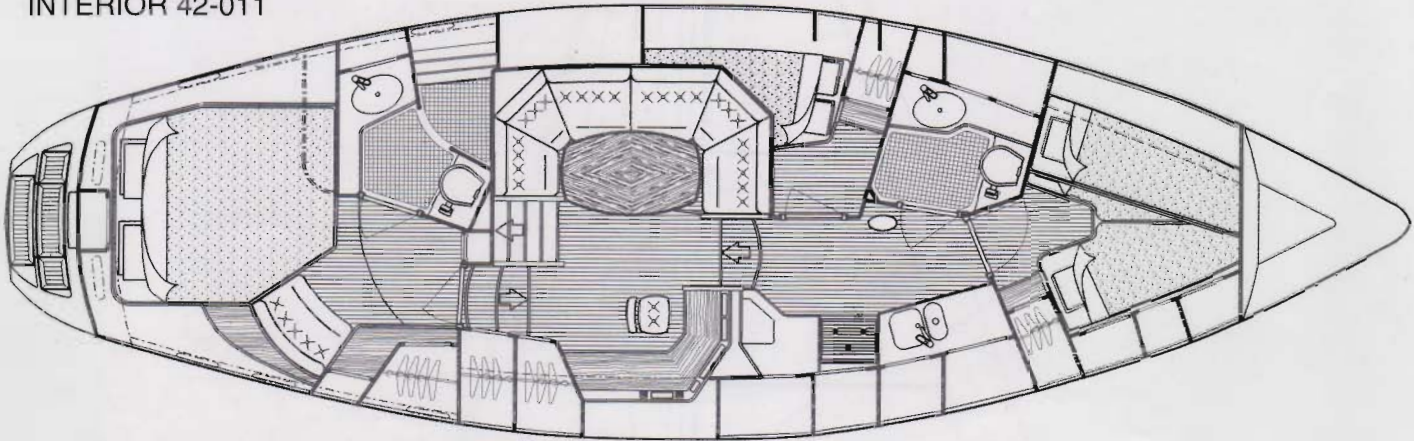

INTERIOR 42-011

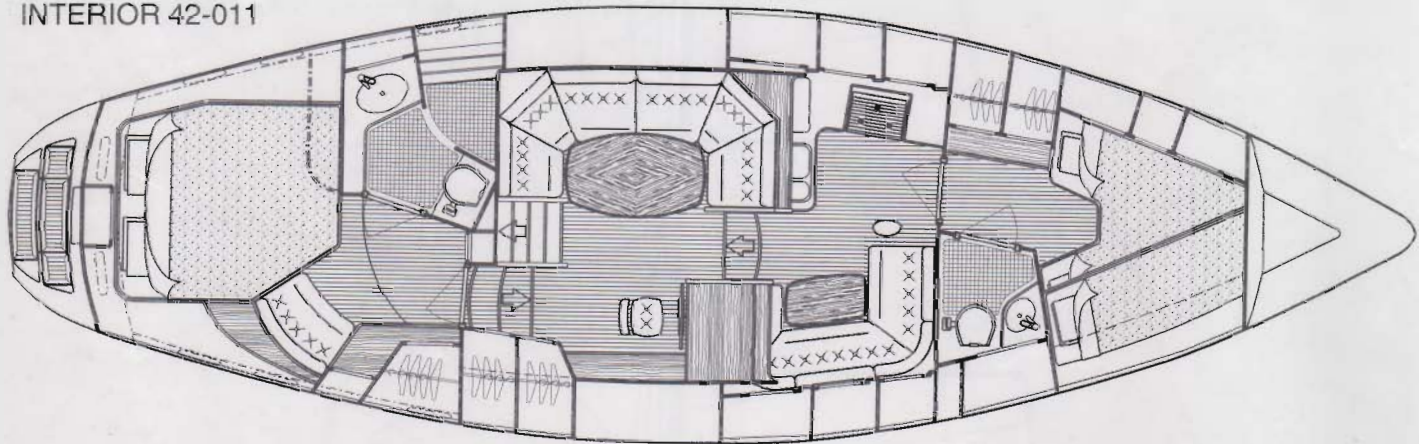

STANDARD HULL COLOURING

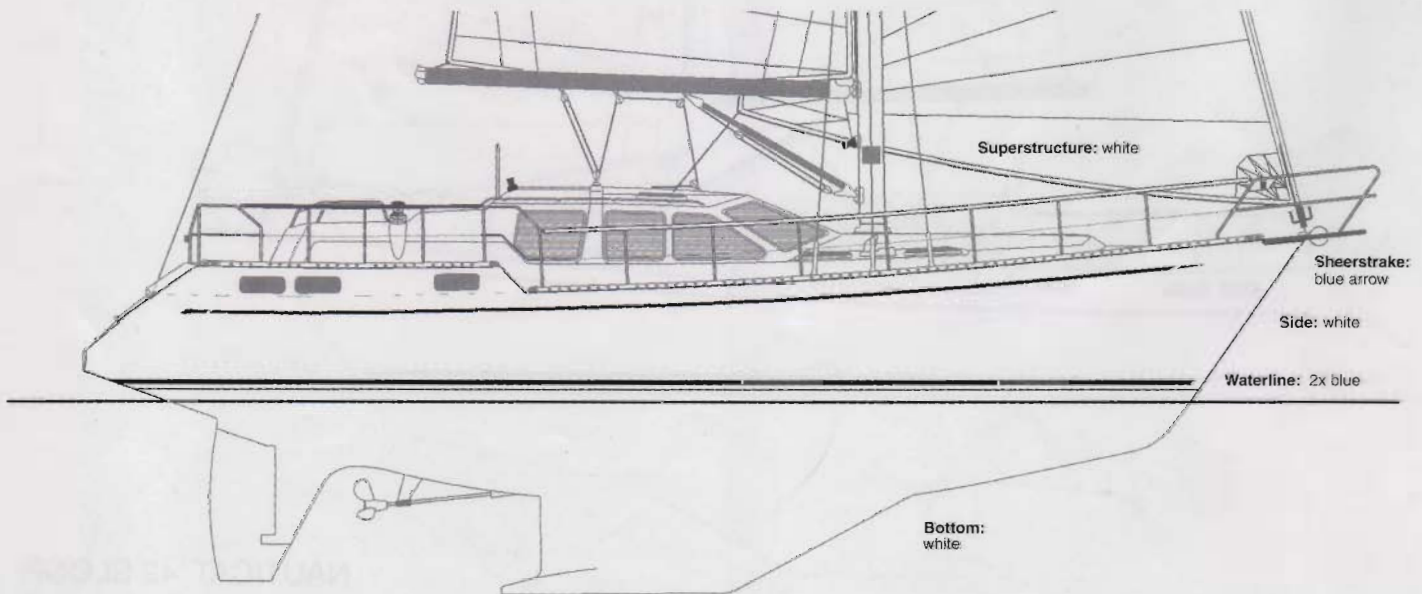

NAUTICAT 42 PILOTHOUSE SAILBOAT STANDARD SPECIFICATIONS

L.O.A.	13,00 m	42'8"
L.W.L.	10,35 m	33'11"
Beam	4,00 m	13'1"
Draft	1,95 m	6'5"
Freeboard, fore	1,65 m	5'5"
Freeboard, aft	1,42 m	4'8"
Displacement, approx.	14,50 tons	31900 lbs
Headroom		
– fore and aft cabin	1,88 m – 1,92 m	6'2" – 6'4"
– pilothouse	1,92 m	6'4"
Ballast	4,6 tons	10100 lbs
Fresh water capacity, approx.	700 l	154 gal. UK
Fuel capacity, approx.	700 l	154 gal. UK
Height above waterline approx.	20,0 m	65'7"
Speed under power, approx.	8 knots	
Cruising range, approx.	800 nautical miles	

SAILS (are offered as an option)	Sail area
Main sail	39,5 m ²
Genoa I	58,0 m ²
Genoa II	48,7 m ²
Jib	32,2 m ²
Storm jib	10,7 m ²
Spinnaker (Tri Radial)	131,0 m ²
Cruising spinnaker	131,0 m ²

Sails manufactured by North Sails.
Masts manufactured by Seldén Mast.
CE approved category A.

HULL AND KEEL

All hand laminated fibreglass construction layers of mat and woven roving. The longitudinal stringers, engine bed and transverse floor bearers form the stiffening of the hull. All main bulkheads and other structural panels are bonded to the hull where appropriate. The engine bed has captive steel plate for the securing of engine mounts. The keel is lead ballast of 4,6 tons. It is secured by acid-proof steel bolts with stainless steel internal backing plates.

DECK AND SUPERSTRUCTURE

Deck and superstructure are an one-piece moulding constructed entirely of hand laminated fibreglass. All surfaces including wheelhouse roof have an anti-slip finish. The self draining anchor well in the foredeck has top access hatches. Four heavy duty bollards with adjacent fairleads are employed for safe mooring of the vessel. All windows are of toughened safetyglass suspended in alloy frames. The guard rail is made of solid teak, which is mounted on stainless steel stanchions. Boarding gates aft and starboard. All external teak wood parts in natural without any treatment. An intermediate line between aluminium toe rail and guard rail. The bowsprit is an option. Line storage space under the step of the transom. Seats in aft deck corners.

ENGINE

The engine is Yanmar 4LH-TE marine diesel (BSO stage II approved), 110 hp/3300 rpm. Gear box reduction 2.6:1, swinging a 22" x 14" LH bronze propeller. The propeller shaft is of 40 mm acidproof steel with heavy duty bronze bushings and lubrication system. Fuel is carried in two tanks, each tank has a deck level filler with vent pipes also at deck level and a separate handpump for taking out the dirt. One single lever Morse control is provided at inner and outer steering stations. An audible alarm indicating oil pressure and temperature malfunctions is fitted in the wheelhouse and at outer steering station. The engine room is well soundinsulated. Space for generator installation.

PLUMBING

All underwater through-hull fittings have bronze seacocks such as the toilet inlet and outlets, engine, galley system, wash basin drains, etc. The fresh water is carried in two stainless steel tanks, 700 l. Both tanks are filled from the deck. An electric water pump supplies all outlets, galley, toilets, etc. Stainless steel double sink in galley, wash basins in toilets. Manual and automatic electric bilge pump with manual override serves to evacuate any water from the bilges. Two marine flushing WCs, septic tank 162 l (43 gal. UK) and a pumpout fitting on deck. Hand shower in forward toilet. Separate shower room in aft toilet.

STEERING

The steering is hydraulic steering with dual station controls; one in the wheelhouse and one in the cockpit. The upper or cockpit unit is enclosed within a binnacle column. Both controls are totally self-contained and connected in parallel. Turn-over rate of

the inner wheel is adjustable, normally 3–6 from turns lock to lock. Rudder of fibreglass, rudder stock of acid-proof steel, bearings of bronze. Emergency steering by way of a tiller connected directly to the rudder stock.

ELECTRICAL SYSTEM

Boat's service is by way of a 12 V D.C. system employing 3 heavy duty lead acid batteries of 1 x 180 Ah and 2 x 220 Ah, housed in a ventilated box in the engine room. A master switch for start and service batteries. The charging system employs a 12 V/80 A alternator with a relay for parallel connection during engine-running. Individual functions controlled by switch panel, including automatic fuses for all consumers with lights. Working lights positioned throughout the vessel where appropriate, including flexible arm chart light and reading lights at berths. All wardrobes have lights. Indirect illumination in the galley. Running lights to international standards.

SPARS AND RIGGING

Sloop rig with silver anodised mast and boom. Internal halyards. The mast is sound-proof. Boom equipped with gas filled Rodkick boomvang. The mast has double spreader configuration. Mast is keel stepped and provided with lighting protection cable to keel bolts. One line slab reefing system on the mast.

Halyard winches:

- 1 x Andersen 28 ST 2-speed
- 1 x Andersen 16 ST 2-speed
- 1 x Andersen 16

Reefing winch:

- 1 x Andersen 16

Standing rigging:

- 1 x 19 ø 8–12 mm, stainless steel wire

Running rigging:

- internal halyards 7 x 19 of stainless steel with rope tails
- sheet of rope ø 14 mm

Sheetwinches:

- fore sail: 2 x Harken 56 STA 2-speed
- main sail: 1 x Harken 40 STA 2-speed

Stainless steel turnbuckles and chainplates.

INTERIOR

Construction of the yacht throughout employs the use of varnished teak faced marine plywood, except the Durant surfaces of the galley and toilet/shower room compartments. The floor board are of teak-faced plywood with light wood striping. Wall-to-wall carpeting in pilothouse. Toilets and shower room floors are of mosaic tiles. Floor drain in toilets. A good selection of upholstery and curtain materials is available to complete the decor. Wheelhouse curtains not included.

FORE CABIN

Within the fore cabin are 3 berths, one V-berth and one upper to the port or the starboard side of the yacht. Generous stowage below bunks to accommodate sleeping bags, small cases, etc. Small table. Full length hanging locker with light inside. Lockers on both sides of the cabin. Dorade vent and aluminium framed translucent opening hatch provides ventilation and light. Reading light for each bunk. Working light on the bulkhead.

FORWARD TOILET

Located by the fore cabin. Pressurised water, basin, marine pump type head and hand shower. Inside the door on the ceiling, there is a curtain rail of aluminium. Ceiling light, 12 V outlet. Storage behind and underneath of basins. Finished in light laminate. Overhead hatch.

SIDE CABIN (OPTIONAL)

Located on port side forward partially under deck salon U-settee. Comfortable wide berth. Openable hatch for light and ventilation. Full height wardrobe with light. Reading light and ceiling light. Storage space behind the berth.

AFT STATEROOM

Approaching the stateroom from the wheelhouse companionway one finds oneself in a very large area with luxurious interior. Included are a large double berth, large, full length hanging locker and dressing table. Drawers. To the rear of the vessel are two windows in the transom giving a feel of depth; Lockers in after corners. Five openable windows. Reading and deckhead working lights.

AFT TOILET / SHOWER ROOM

In spacious aft head with separate WC and shower rooms you can find pressurised water, basin, marine pump type head and wall-

shower. Shower room can be used as wet locker. Inside the door on the ceiling, there is a curtain rail of aluminium. Ceiling light, 12V outlet. Mirror. Openable window. Finished in light laminate. Door to the engine room.

DINETTE (OPTIONAL)

Opposite to the galley on the starboard side is a dinette with U-sofa for up to six persons. High/low table converts the dinette to an extra double berth if required. Shelves and lockers. Barlocker with mirror. Storage space under the sofa. Reading and deck head working lights. Indirect lights both in dinette and pantry. Dorade vent and aluminium framed translucent opening hatch for ventilation and additional light.

GALLEY

The galley is in L-shape in dinette version on port side and in side cabin version the galley is in straight line and located on the starboard side with good worktop surfaces in formica. Two burner gimbaled gas stove with oven, flame guards. Double stainless steel sink and toploading refrigerator, 100 l. In addition to the already commodious storage beneath the Durant worktops there are overhead cupboards. Cutting board, drawers for silverware, trash pail. Dorade vent and aluminium framed translucent openable hatch provides ventilation and light.

PILOTHOUSE AND DECK SALOON

This is an area of immense proportions providing unimpaired visibility to all directions through aluminium framed safetyglass windows. At the aft end of the wheelhouse there is the companionway stairs leading to the cockpit and upper station. Conveniently situated at the yacht's navigation centre is the engine control, engine instrument display, compass, echo sounder, speed and distance electronic log, hand searchlight and signal horn control. Large navigation chart table with storage under a hinged lid is forward of the wheel. Flexible chart light. Two aluminium framed translucent hatches are set into the wheelhouse roof. Sliding hatch for cockpit to wheelhouse companion way with dovetail washboards. The master switch panel. Two working lights are provided on the deckhead. On starboard side there is a lot of space for autopilot, radar GPS and other electronics. Large U-sofa to the port side will seat up to 7-8 persons in comfort. Stowage beneath the sofa.

EQUIPMENT

Anchors and warps	1 x 30 kg (66 lbs) Bruce anchor, 1 x 16 kg (35 lbs) Danforth type anchor. 5 m (16') chain, 2 x 50 m (2 x 164') warps. Aluminium bow roll.
Anchor box	One forward. Storage with drainage for gas bottle.
Bar locker	In pilothouse and dinette with rack bottles etc.
Batteries	2x220 Ah for service and 1x180 Ah for start.
Bilge pump	Manual and automatic electric bilge pump.
Boarding ladder	At stern.
Bollards	2 forward and 2 aft.
Compass	Suunto D135, lighted, on cockpit pedestal.
Depth sounder	Autohelm ST60.
Electric outlets	12 V, in toilets, wheelhouse, cockpit.
Emergency steering	Direct to rudder stock.
Fairleads	2 forward and 2 aft.
Fenders	4 fenders.
Fire extinguishers	1 x 2 kg (4 lbs), 1 x 6 kg (16 lbs).
Holding tank	162 l (43 gal. UK) with emptying from deck or to sea.
Hooks	4 pcs for lifeline.
Horn	Electric marine horn.
Instruments	1 tachometer 1 engine oil pressure gauge 1 water temperature gauge 1 ampere meter 1 volt meter 2 fuel gauges 1 engine hour meter.
Lifebuoys	2 horseshoe type with holders.

Life rails	Stainless steel stanchions, handrail of teak, with lifelines, gate on sb-side.
Lights	Navigation, steaming and anchor lights according to international rules. Flood lights Chart light in pilothouse Searchlight Lights in all cabins Reading lights at berths Indirect lights in galley/dinette and aft cabin Lights in hanging lockers.
Log	Autohelm ST 60 speed and distance recorder, trip recorder.
Mooring warps	4 x 15 m (4 x 49').
Navigation table	In pilothouse, storage space for charts.
Refrigeration	Approx. 100 l insulated box, cooled by electric 12 V compressor.
Repair kit	Gelcoat in hull colour, 1 l.
Sink	Stainless steel double sink in galley.
Stove	Propane gas stove with two burners and oven, flame guards, gimbaled.
Switch board	Star/stop switch 1 signal horn switch 3 windshield wiper switches Warning signals for malfunction of engine oil pressure and engine temperatures (at both steering stations) 1 switch for pressurised water Switches for navigation and anchor lights All instruments are illuminated.
Toilets	One forward, one aft, marine pump type toilets.
Ventilation	Pilothouse is ventilated through alloy framed hatches and openable windows. Hatches also above the galley, dinette fore cabin and forward toilet. Sliding hatch above the companionway from wheelhouse to the cockpit. Openable windows in aft cabin and aft toilet. Dorade vents with stainless steel shelters above forward cabin, galley, dinette and forward toilet.
Water pressure	Pressurised water in galley, toilets and shower room.
Water tank	700 litres in two stainless steel tanks, three way valve.
Wash basin	In forward and aft toilets.
Winch handles	1 x 8", 2 x 10" with lock.
Windshield wipers	Three in front windows.

Siltala Yachts Oy tries to improve its products by using latest techniques and equipment while still maintaining the high standards. Therefore it might be necessary to alter the specifications from time to time. Siltala Yachts reserves the right to alter specifications without prior notice. The pictures may show options. See also your dealer's additional specifications as variation appear due to national safety rules. All dimensions mentioned in this standard specification are approximate.

Siltala Yachts Oy has during its existence evolved to one of the leading boatyards, building traditional motorsailers and pilothouse sailboats. At the end of the year 2001 over 2550 Nauticats have been launched in different parts of the world. In addition to the famous "Grand Old Lady", the Nauticat 331, the current range compresses the traditional motorsailers, Nauticat 38 and 44. The sloops Nauticat 321, 35, 37, 39, 42 and 515 we call pilothouse sailboats.



Builder and Head Office

SILTALA YACHTS OY

Lallintie 92

FIN- 21870 Riihikoski, FINLAND

Telephone: + 358-2-486 400

Telefax: + 358-2-486 8500

siltala.yachts@siltala.fi <http://www.nauticat.com>